

# Central-Snap Condition Details

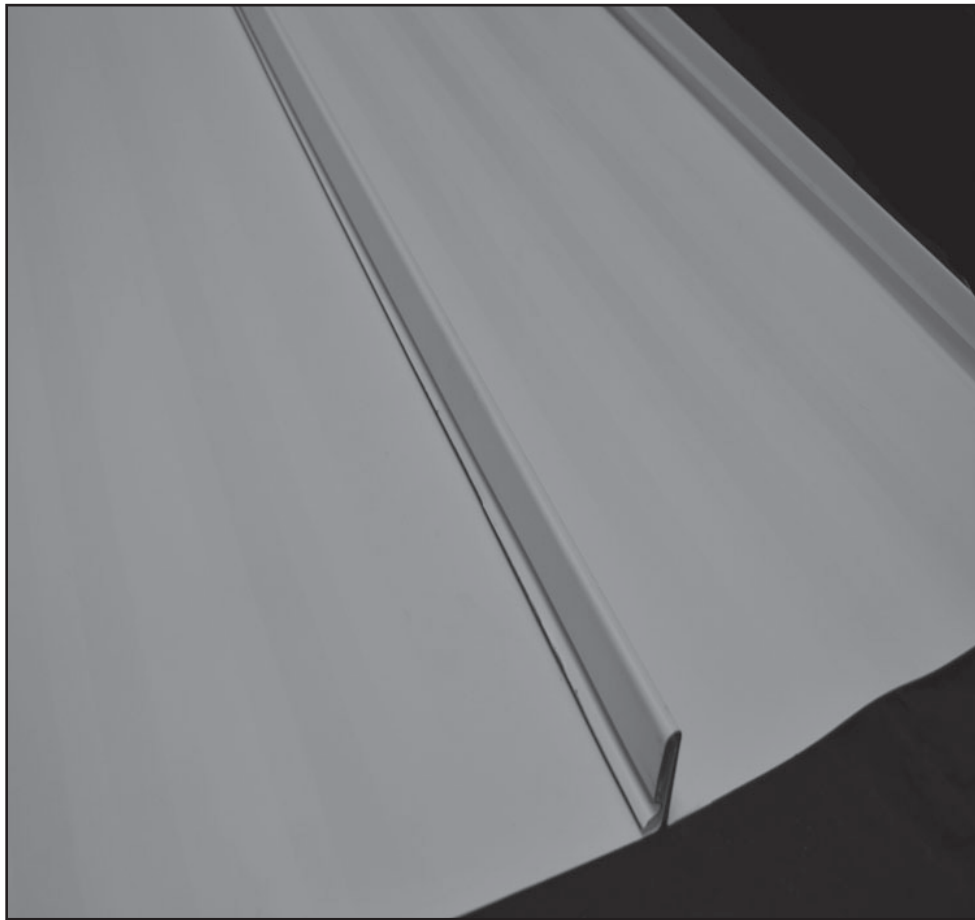

**CENTRAL  
STATES**

MANUFACTURING, INC.  
METAL BUILDING COMPONENTS  
[WWW.CENTRALSTATESMFG.COM](http://WWW.CENTRALSTATESMFG.COM)





# Central-Snap

## Vertical 1<sup>3</sup>/<sub>4</sub>"

### Standing Seam Roof Panel

Installation is a Snap with **Central-Snap** from



Central States offers a vertical 1<sup>3</sup>/<sub>4</sub>" snap-lock standing seam panel system that is sturdy and fire resistant, making it ideal for architectural and commercial applications. Its Galvalume substrate offers two to four times the corrosion resistance of galvanized steel.

Comprehensive condition details are available and come attached to each order. Central States also carries an extensive line of standing seam trims and accessories to complement this panel.

## Standing Seam Roofing Features:

- Subtle striations between ribs on 16" and wider panels reduce the appearance of oil-canning.
- Available in 24 gauge in 17 standard colors in the Kynar® (polyvinylidene fluoride) coating system.
- Tested in accordance with UL580 & ASTM E1592.
- Meets UL 90 wind uplift requirement for all panel widths offered.
- Should be installed over solid substrates but can be installed over open framing depending upon the panel width and support member spans.
- Available with a 1-1/8" notch at one or both ends of each panel for the ease of turning under; reducing installation labor and costs.
- Factory applied hot melt sealant is standard.
- Snap-together panel, no field seaming required.
- Recommended minimum slope of 3:12.

**CENTRAL STATES  
MANUFACTURING**

302 Jane Place  
Lowell, AR 72745  
Phone: 800-356-2733  
Fax: 800-356-2971  
www.centralstatesmfg.com



**CENTRAL - SNAP  
GABLE DETAIL**

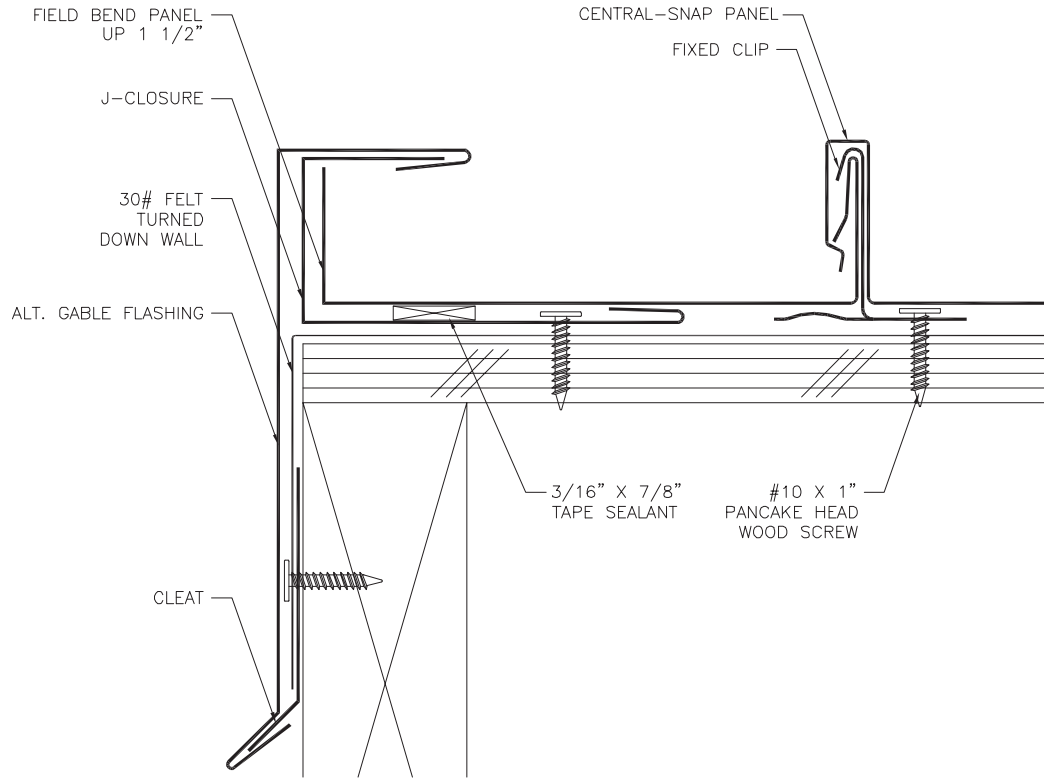

**FLASHING COMPONENTS**

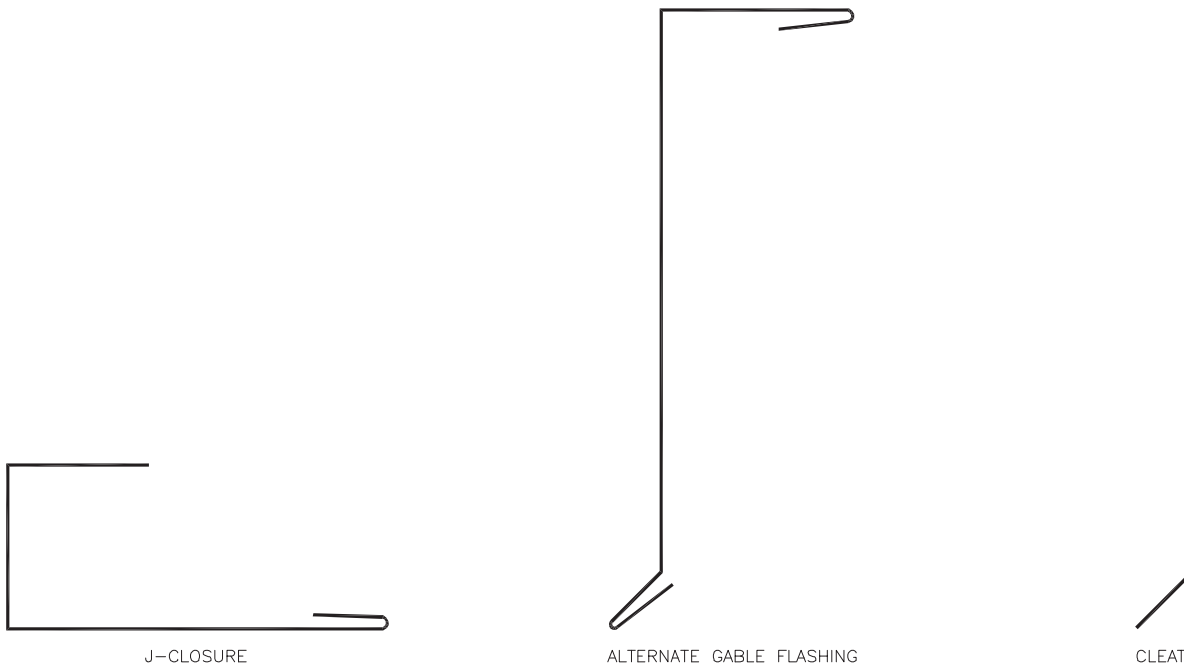

**CENTRAL STATES  
MANUFACTURING**

302 Jane Place  
Lowell, AR 72745  
Phone: 800-356-2733  
Fax: 800-356-2971  
www.centralstatesmfg.com



**CENTRAL - SNAP**  
**ALTERNATE GABLE DETAIL**

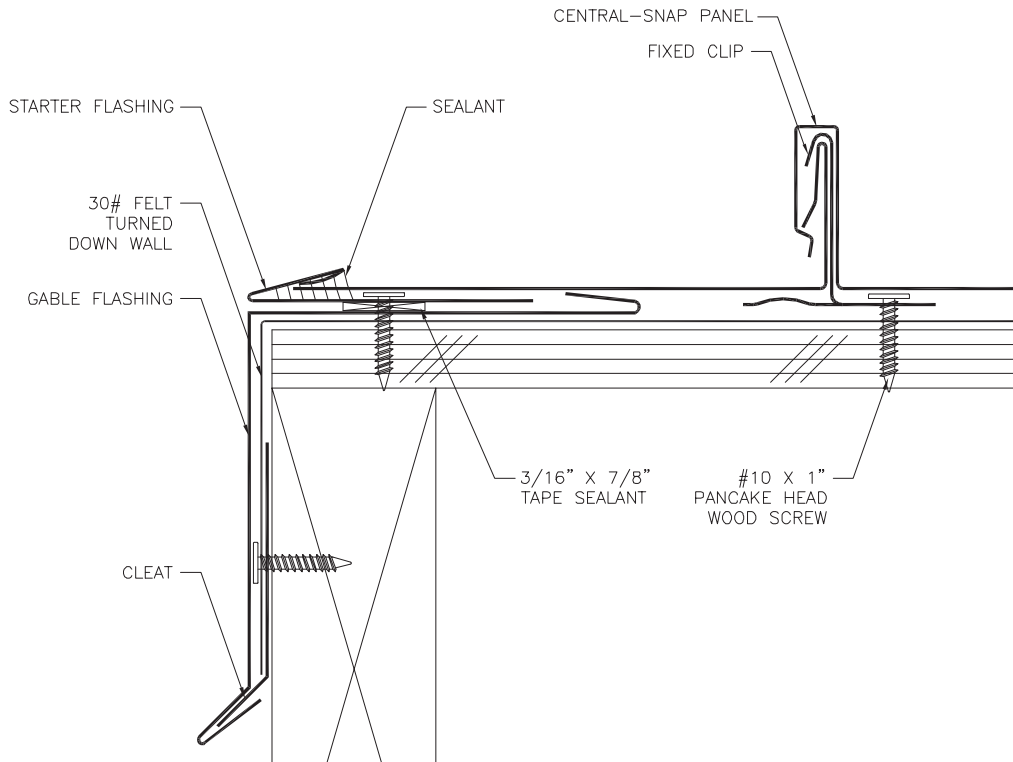

**FLASHING COMPONENTS**

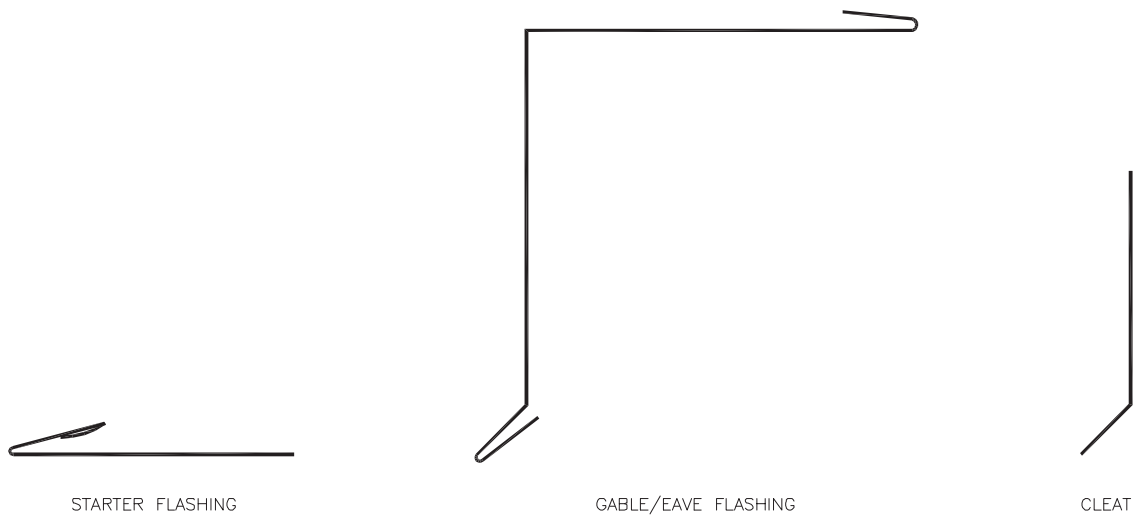

**CENTRAL STATES  
MANUFACTURING**

302 Jane Place  
Lowell, AR 72745  
Phone: 800-356-2733  
Fax: 800-356-2971  
www.centralstatesmfg.com



**CENTRAL - SNAP**

**ENDWALL DETAIL**

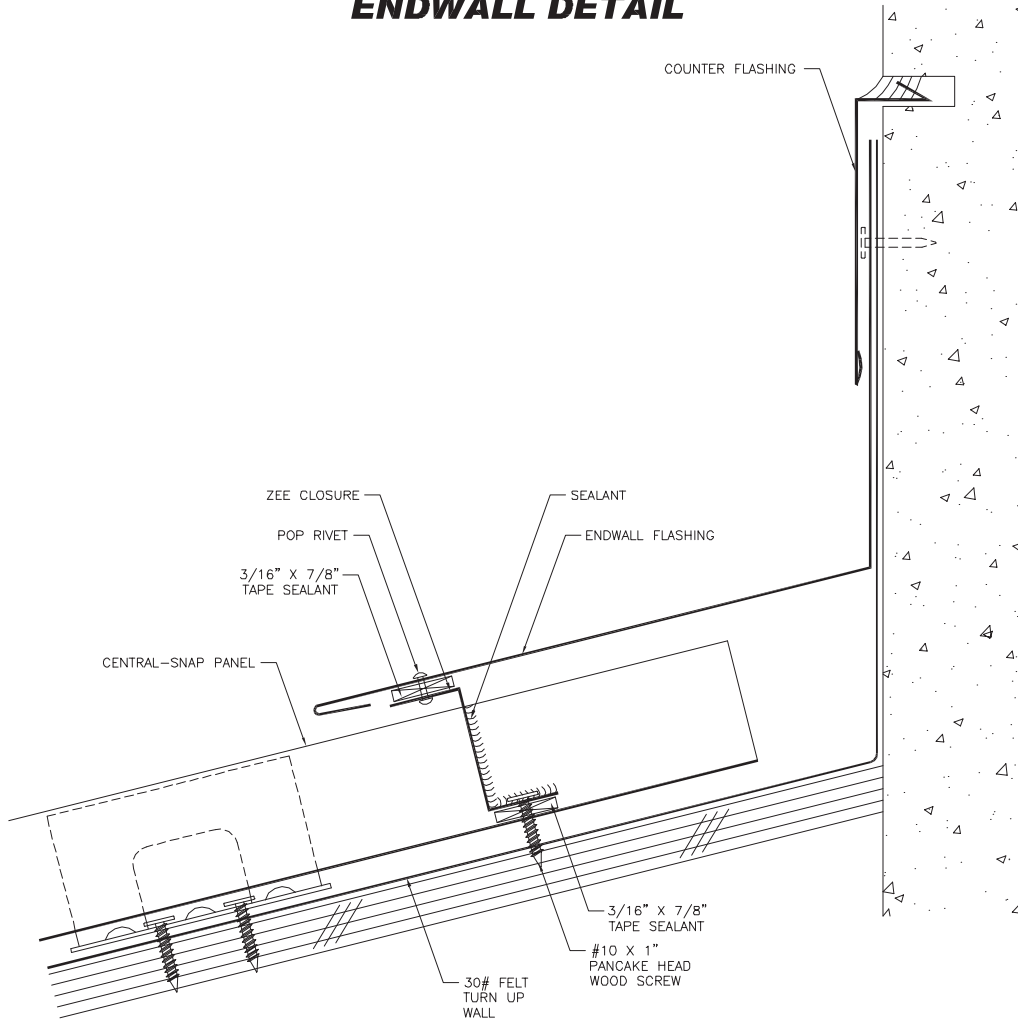

**FLASHING COMPONENTS**

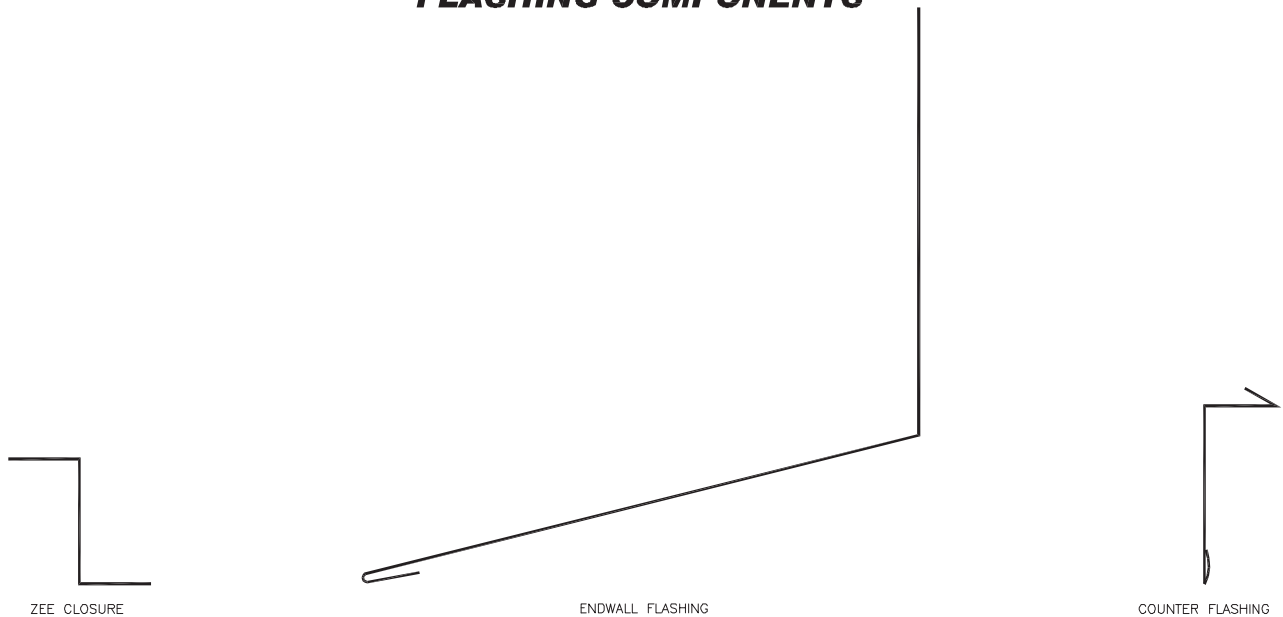

**CENTRAL STATES  
MANUFACTURING**

302 Jane Place  
Lowell, AR 72745  
Phone: 800-356-2733  
Fax: 800-356-2971  
www.centralstatesmfg.com



**CENTRAL - SNAP  
RAKEWALL DETAIL**

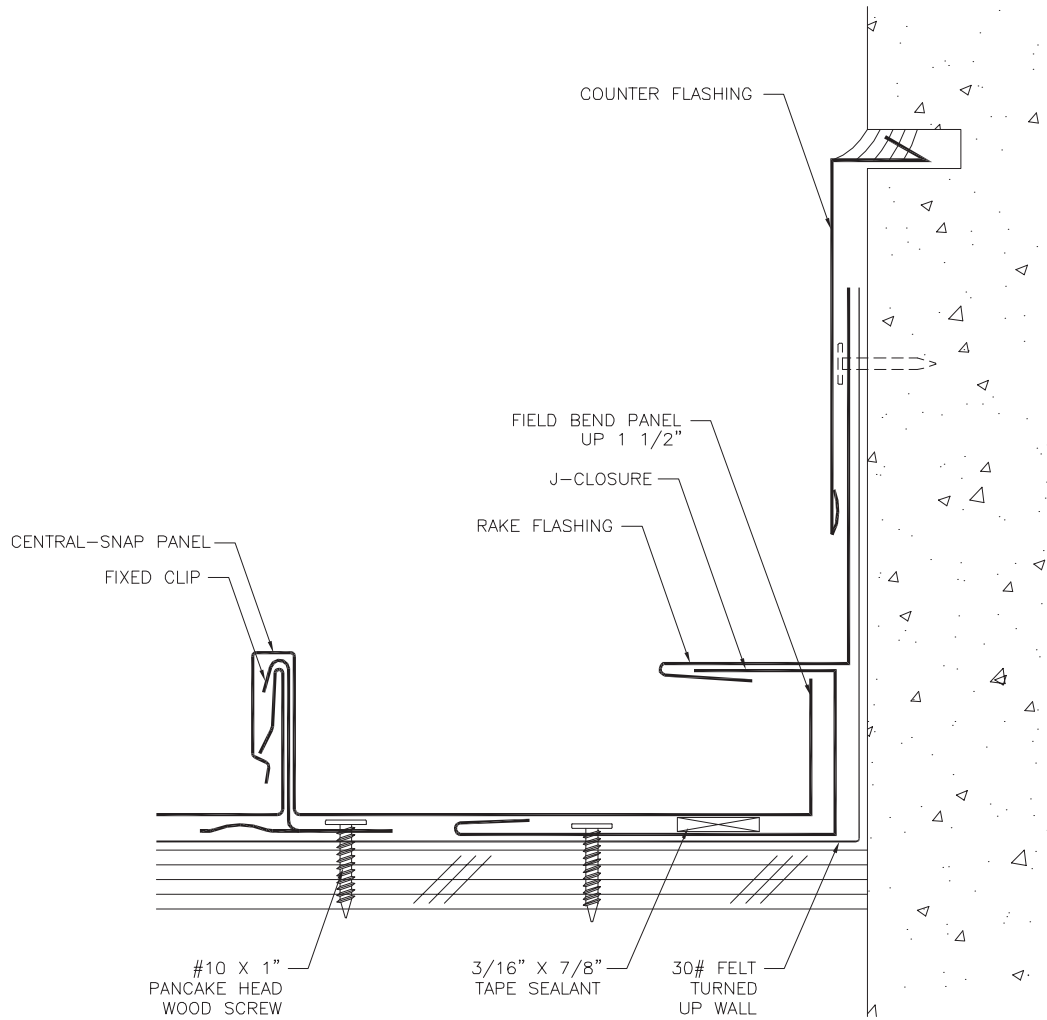

**FLASHING COMPONENTS**



COUNTER FLASHING



RAKE FLASHING



J-CLOSURE

# CENTRAL STATES MANUFACTURING

302 Jane Place  
Lowell, AR 72745  
Phone: 800-356-2733  
Fax: 800-356-2971  
www.centralstatesmfg.com



## CENTRAL - SNAP GUTTER DETAIL

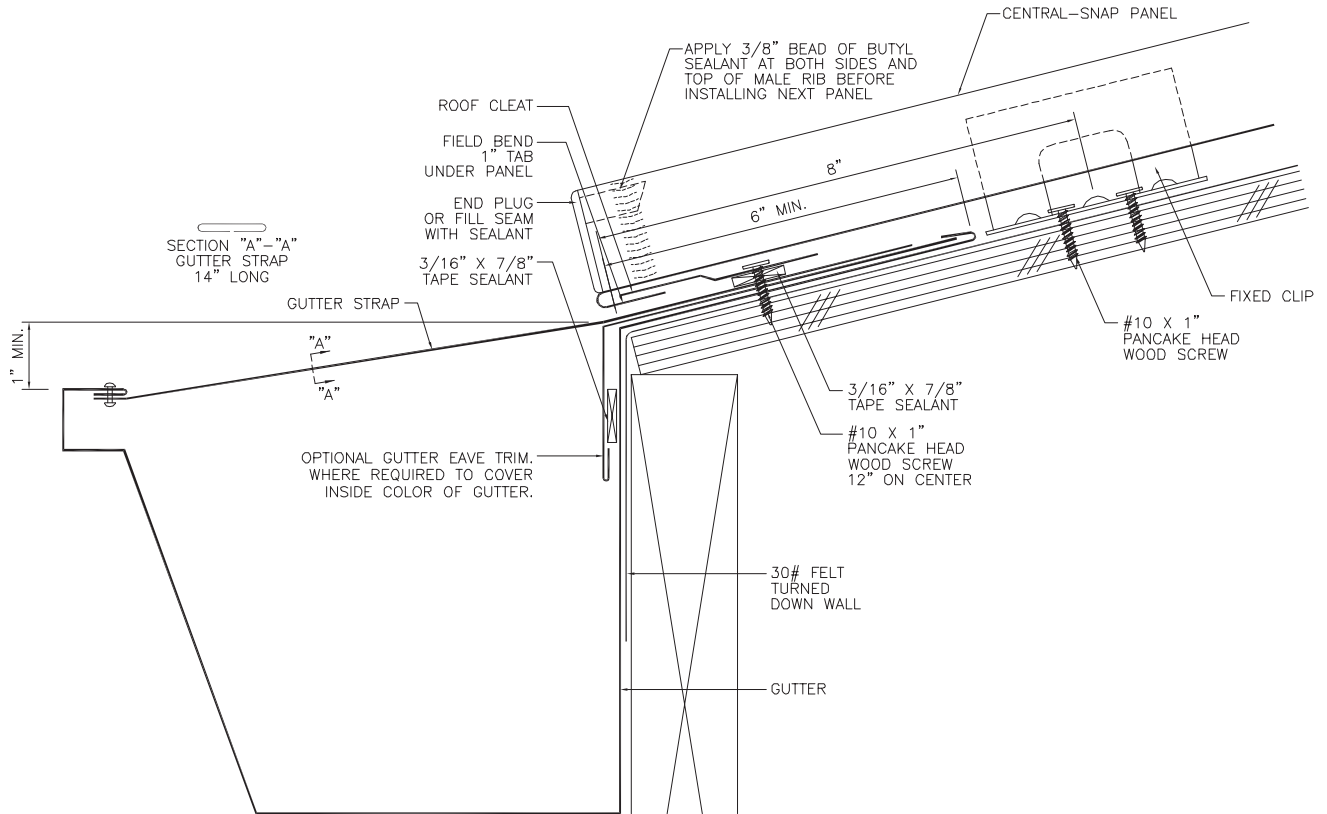

## FLASHING COMPONENTS

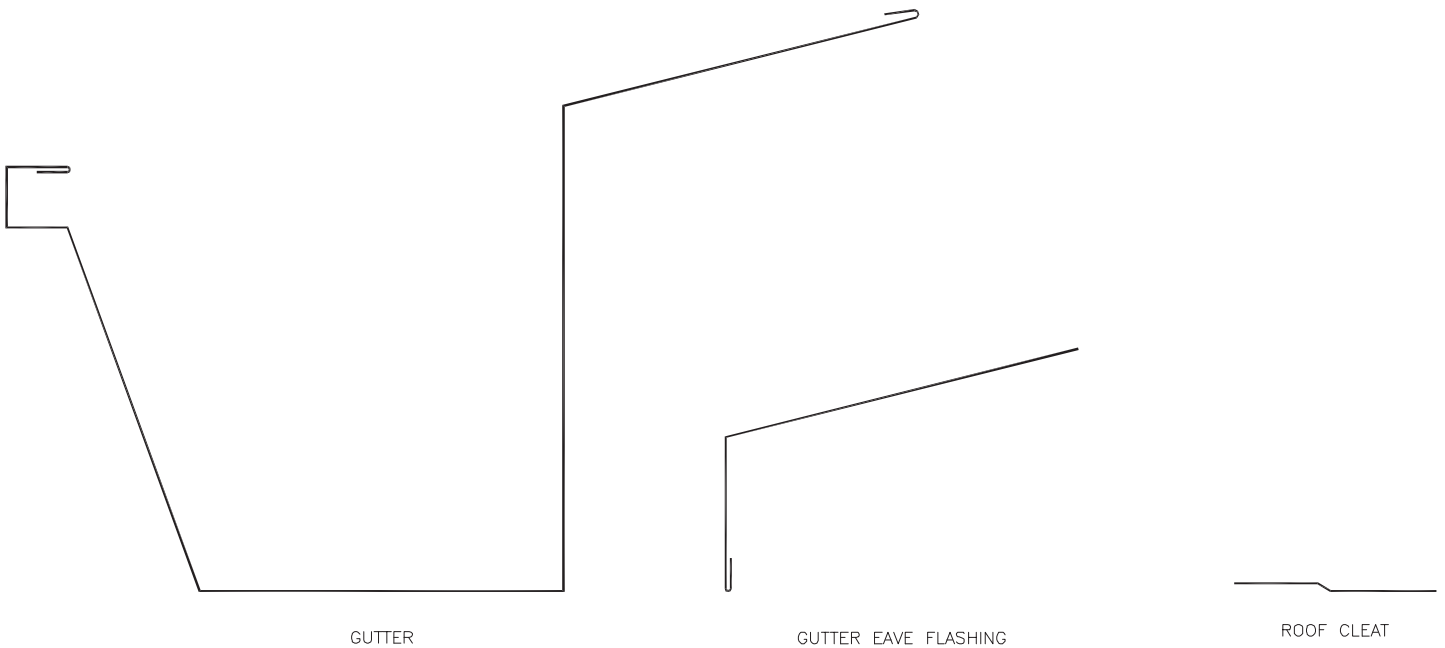

**CENTRAL STATES  
MANUFACTURING**

302 Jane Place  
Lowell, AR 72745  
Phone: 800-356-2733  
Fax: 800-356-2971  
www.centralstatesmfg.com



**CENTRAL - SNAP**

**EAVE DETAIL**

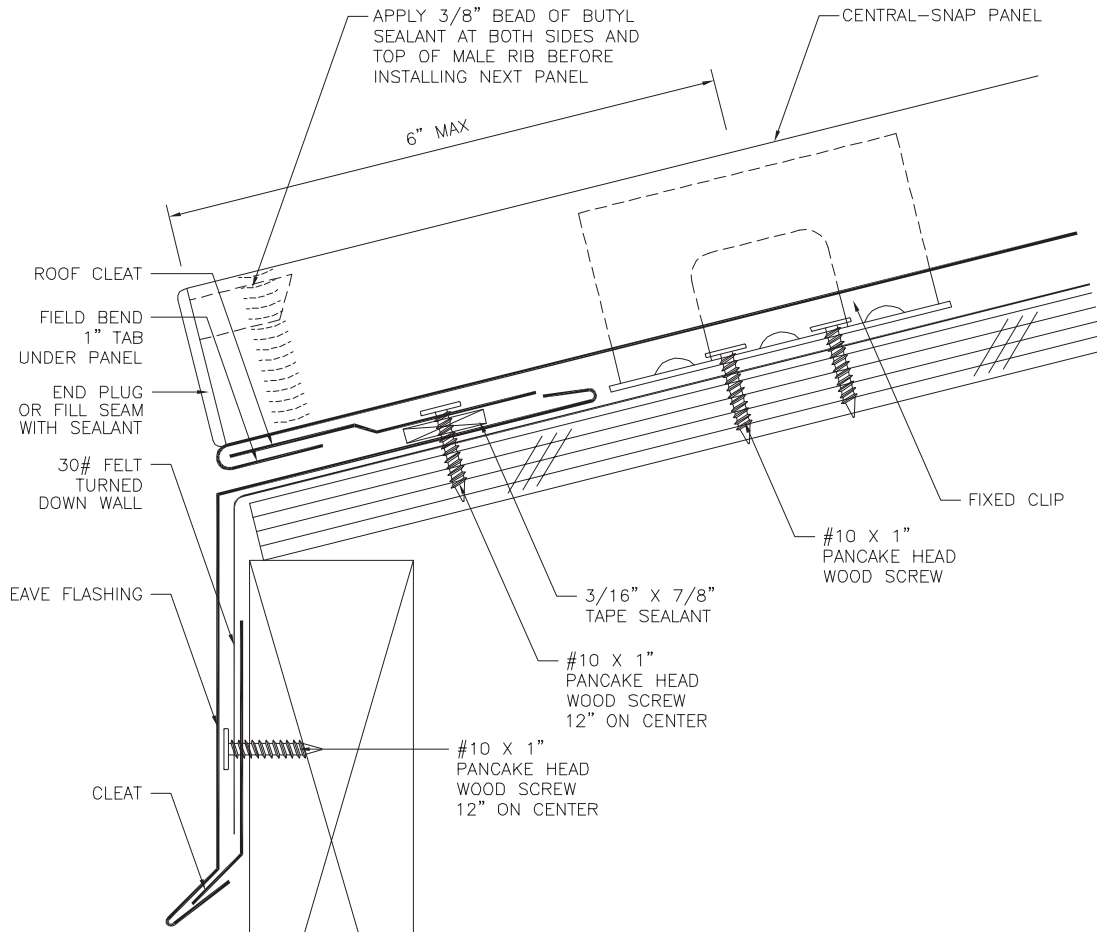

**FLASHING COMPONENTS**

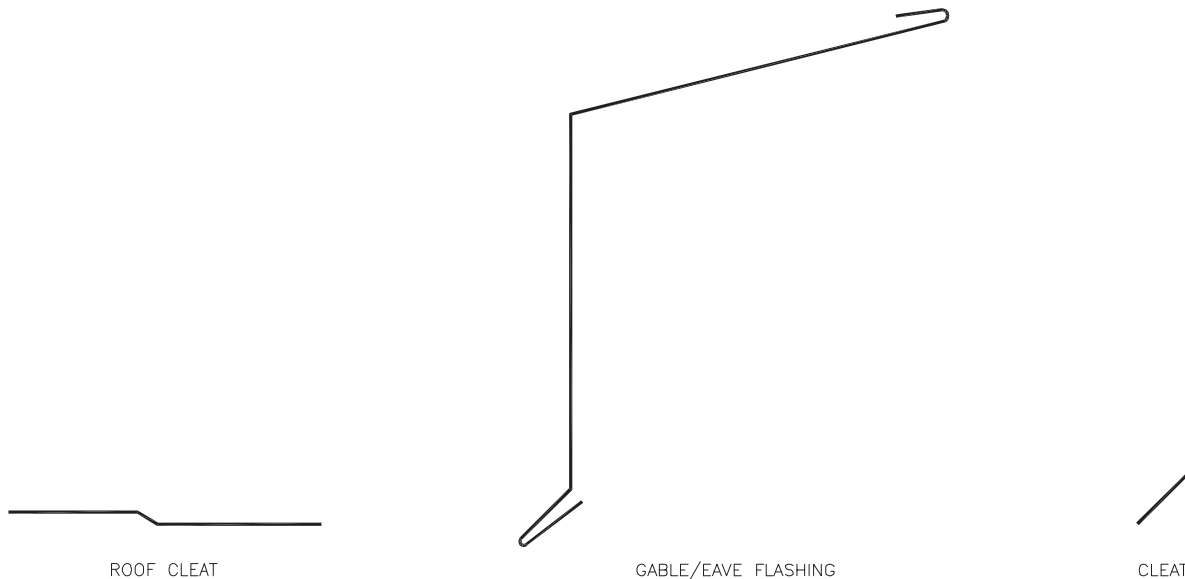

**CENTRAL STATES  
MANUFACTURING**

302 Jane Place  
Lowell, AR 72745  
Phone: 800-356-2733  
Fax: 800-356-2971  
www.centralstatesmfg.com



**CENTRAL - SNAP  
RIB COVER EAVE DETAIL**

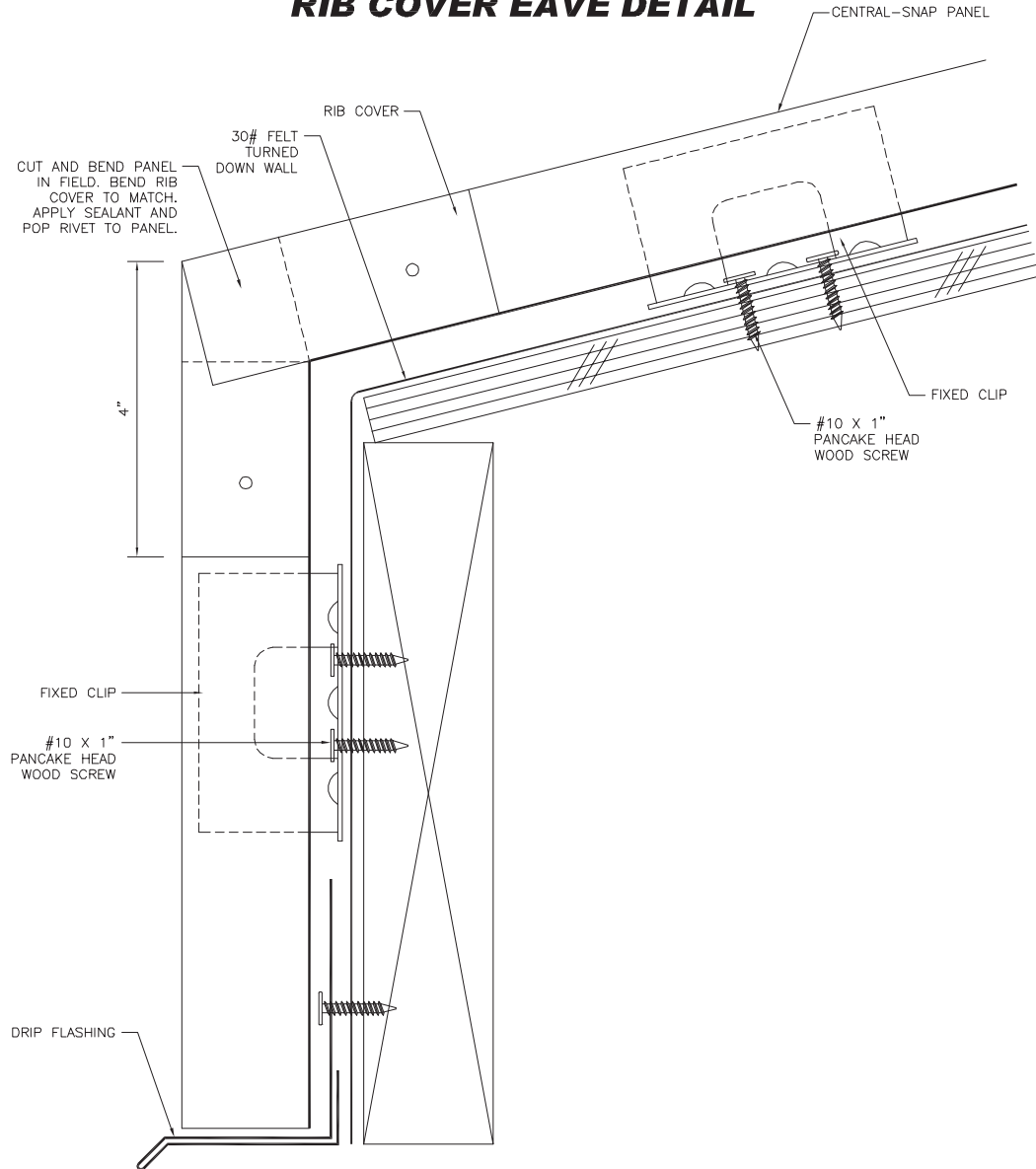

**FLASHING COMPONENTS**

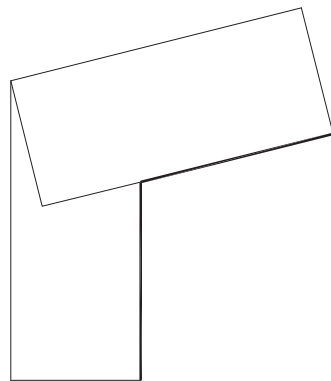

RIB COVER  
(BEND IN FIELD)



DRIP FLASHING

**CENTRAL STATES  
MANUFACTURING**

302 Jane Place  
Lowell, AR 72745  
Phone: 800-356-2733  
Fax: 800-356-2971  
www.centralstatesmfg.com



**CENTRAL - SNAP  
VALLEY DETAIL**

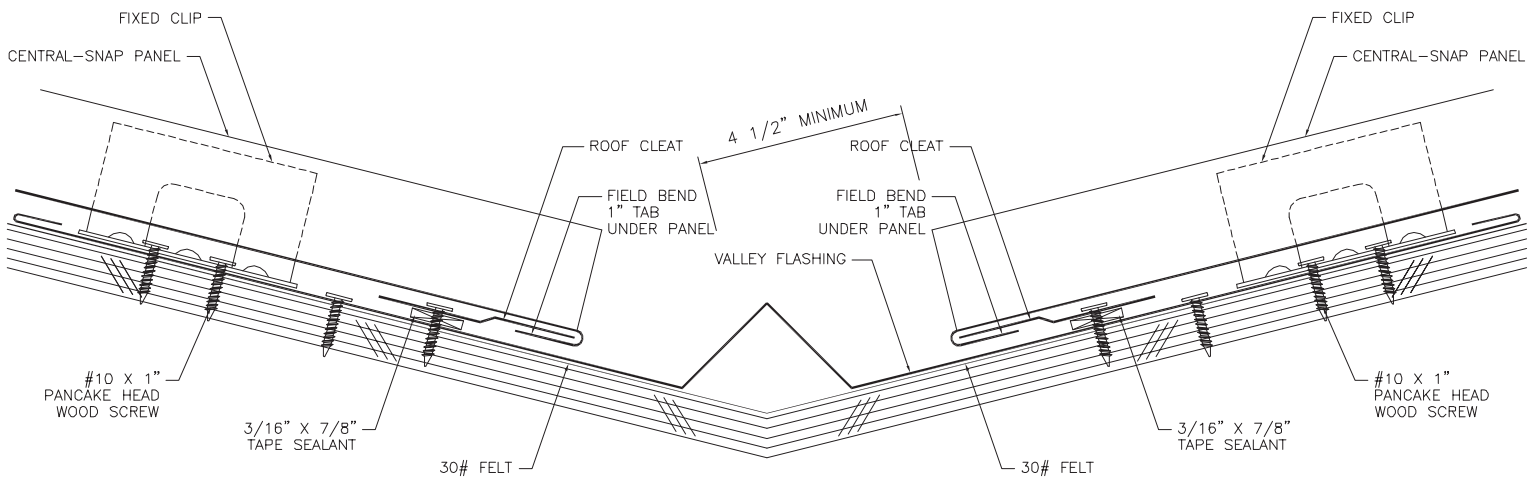

**FLASHING COMPONENTS**

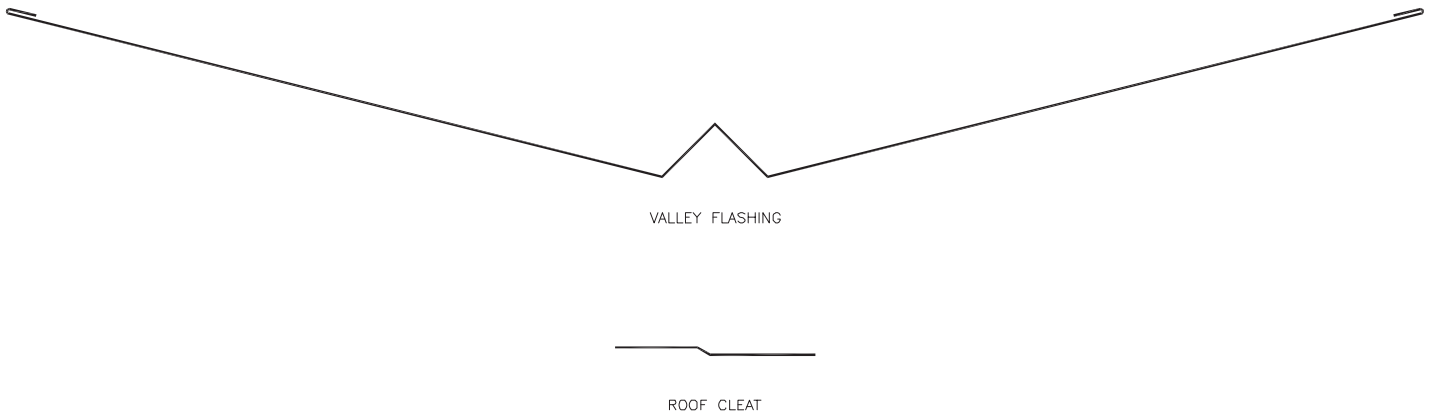

**CENTRAL STATES  
MANUFACTURING**

302 Jane Place  
Lowell, AR 72745  
Phone: 800-356-2733  
Fax: 800-356-2971  
www.centralstatesmfg.com



**CENTRAL - SNAP  
HIP / RIDGE DETAIL**

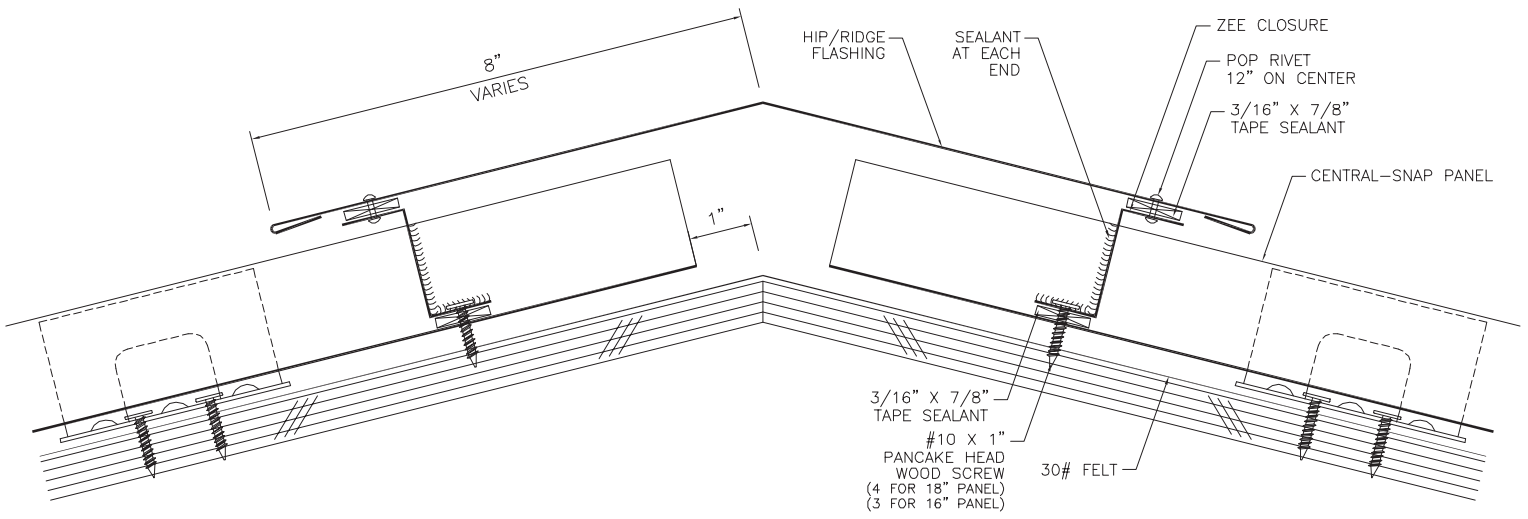

**FLASHING COMPONENTS**

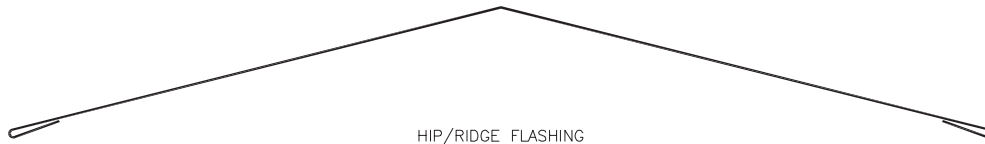

HIP/RIDGE FLASHING

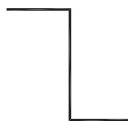

ZEE CLOSURE

**CENTRAL STATES  
MANUFACTURING**

302 Jane Place  
Lowell, AR 72745  
Phone: 800-356-2733  
Fax: 800-356-2971  
www.centralstatesmfg.com



**CENTRAL - SNAP  
PITCH TRANSITION DETAIL**

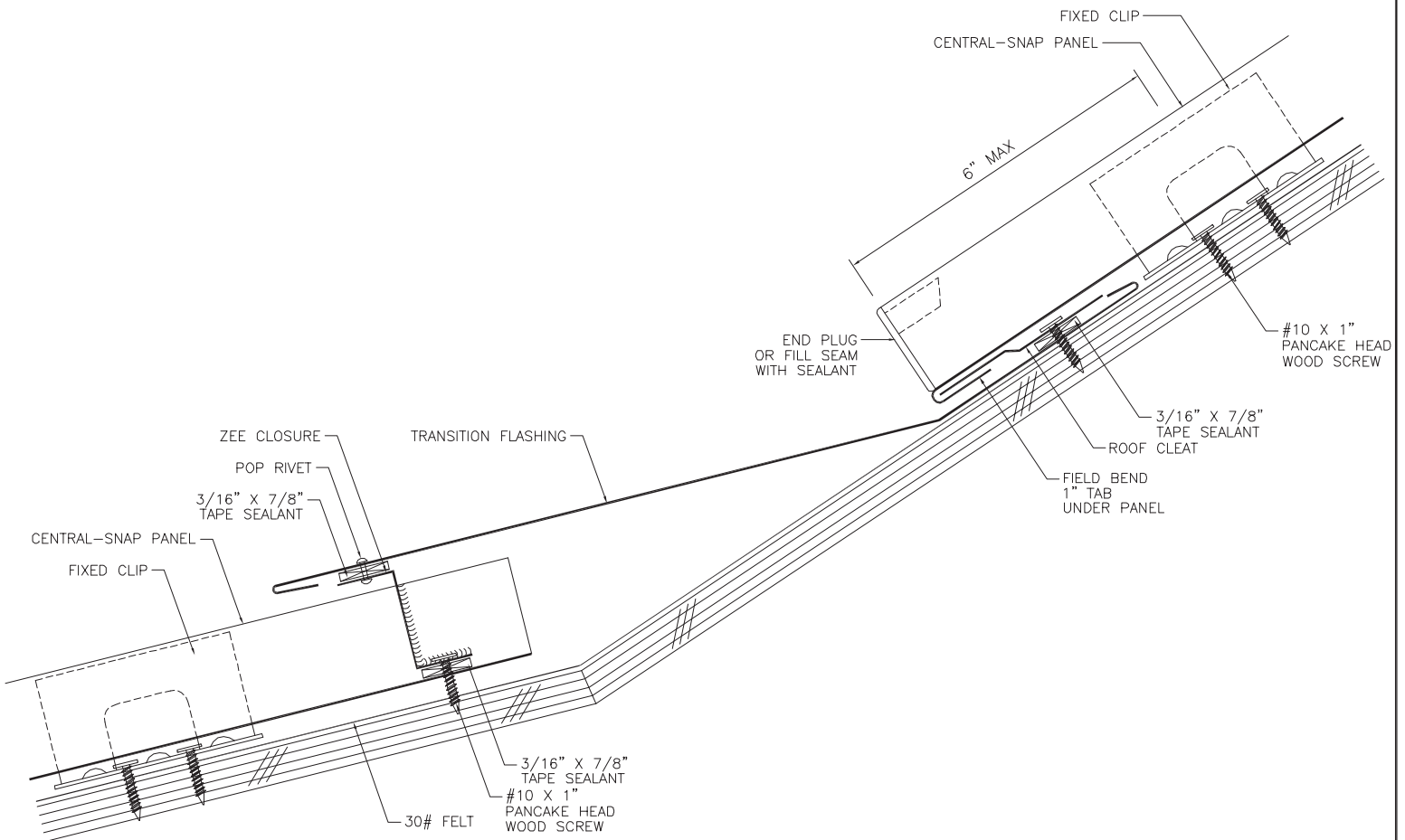

**FLASHING COMPONENTS**

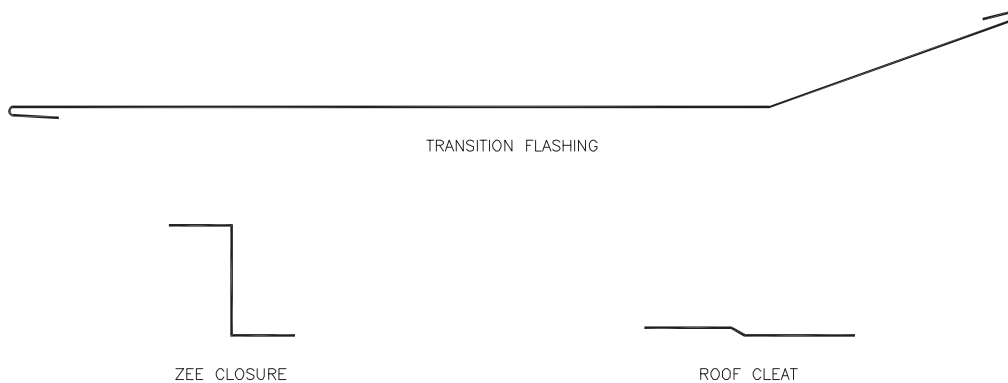

**CENTRAL STATES  
MANUFACTURING**

302 Jane Place  
Lowell, AR 72745  
Phone: 800-356-2733  
Fax: 800-356-2971  
www.centralstatesmfg.com



**CENTRAL - SNAP**

**PANEL NOTCH**

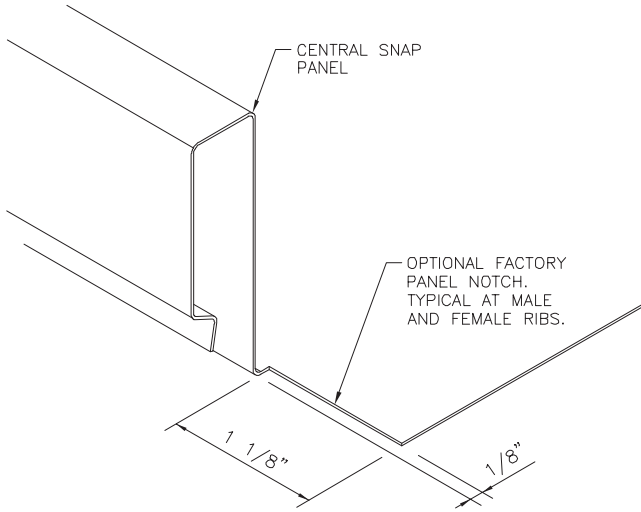

**LAP SEAL**

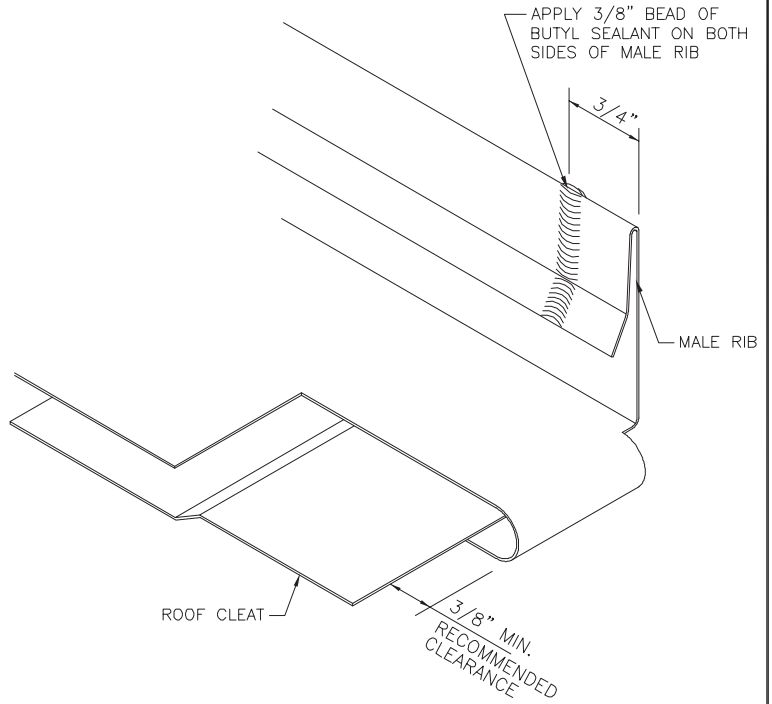

**PANEL HEM**

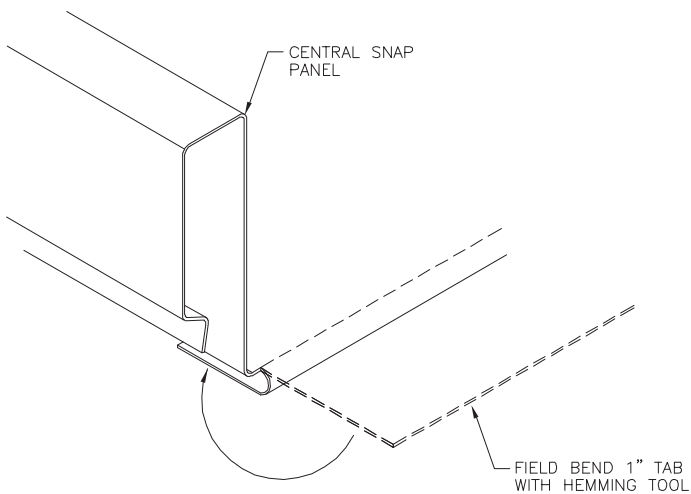

**END PLUG**

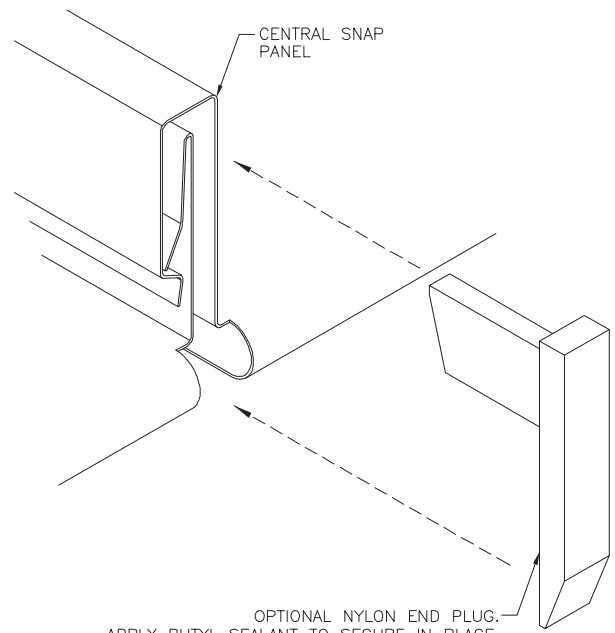

OPTIONAL NYLON END PLUG.  
APPLY BUTYL SEALANT TO SECURE IN PLACE.  
NYLON END PLUG IS NOT RECOMMENDED  
IN HIGH SNOW LOAD AREAS.  
WHEN END PLUG IS NOT USED,  
FILL SEAM WITH SEALANT.

**CENTRAL STATES  
MANUFACTURING**

302 Jane Place  
Lowell, AR 72745  
Phone: 800-356-2733  
Fax: 800-356-2971  
www.centralstatesmfg.com



**CENTRAL - SNAP**

**UL 90 CLIP**

**Part Code: CSLCLP**

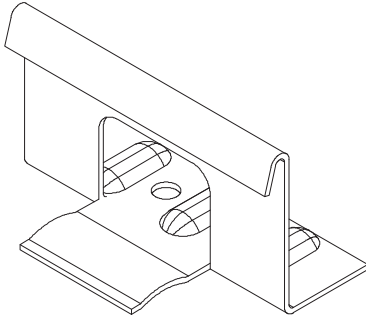

**TUBE SEALANT**

**Part Code: GEOC  
GEOG  
GEOW**

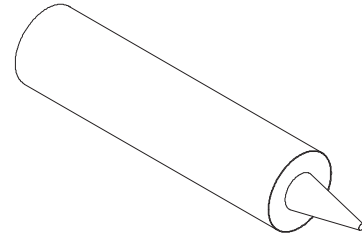

**FASTENER- METAL**

**Part Code: 12FASTENER**  
**#12-10 X 1 Pan Head**



**FASTENER- WOOD**

**Part Code: CSLWFAST**  
**#10-9 X 1 Wood**

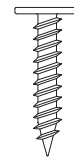

**TAPE SEALANT**

**Part Code: BTR**  
**3/16" x 7/8"x40'**

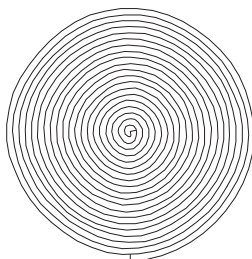

**POP RIVETS**

**Part Code: POP(color)**  
**1/8" Pop Rivet**





# **CENTRAL STATES**

**MANUFACTURING, INC.  
METAL BUILDING COMPONENTS  
[WWW.CENTRALSTATESMFG.COM](http://WWW.CENTRALSTATESMFG.COM)**

302 Jane Place  
Lowell, AR 72745  
800-356-2733

2051 Tryon Road  
Michigan City, IN 46360  
800-638-2565

660 Grigsby Way  
Cedar Hill, TX 75104  
800-210-8305

3402 Industrial Drive  
Jasper, AL 35501  
866-270-6608

751 Piedmont Triad West Drive  
Mount Airy, NC 27030  
877-813-2111